

New Bed Rack System Installation Manual

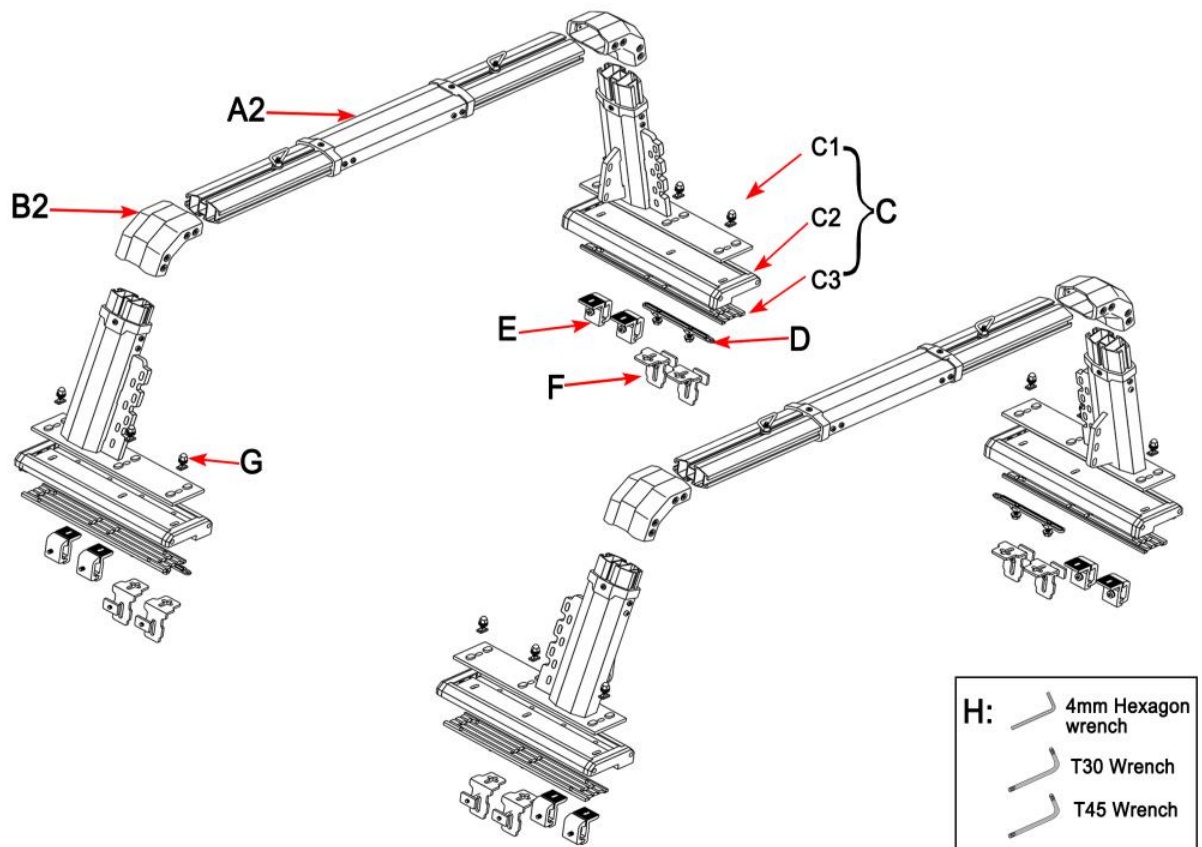

Accessories List of Bed Rack

A2 Cross bar accessories list		
NO.	PART NAME	QTY
1	Side cross beam inner tube	4
2	Side cross beam outer tube	8
3	RUBBER STRIP	6
4	Rings	4
5	shaped gasket	4
6	M8*28 T-Screw	4
7	M6*14 Torx Screw	16
8	M8*8 Torx Screw	8
9	M6 spring washer	16
10	M6 flat gasket	16
11	Plastic ring (decorative part)	16
12	Aquare double-hole M6 Nut	8

B2 Cross Bar Corners		
NO.	PART NAME	QTY
1	Wrapped Corners	4
2	Aquare double-hole M6 Nut	16
3	M6*14 Torx Screw	32
4	M6 spring washer	32
5	M6 flat gasket	32

D Track mounting accessories (Universal)		
NO.	PART NAME	QTY
1	Nut Clamp	4
2	M8 Square nuts(16*16)	8
3	M8*35 set screws	8
4	M8 Flange Nut	8
5	M8 flat gasket	8

C Multifunctional Bracket(universal)		
NO.	PART NAME	QTY
1	C1 Adjustable main tube	4
2	C1 Multifunctional Bracket	4
3	C1 Plastic ring (decorative part)	4
4	C1 M6*8 Torx Screw	8
5	C1 Aquare double-hole M6 Nut	8
6	C1 M6*16 Torx Screw	16
7	C1 M6 spring washer	16
8	C1 M6 flat gasket	16
9	C1 plastic plug	24
10	C2 Bracket Base	4
11	C2 Bracket Wrap Corner	8
12	C2 M6*16 Stainless steel round head screws	16
13	C3 Base leather cushion	4

E Original position clamping		
NO.	PART NAME	QTY
1	Aluminum Clips-Left	8
2	Aluminum Clips-Right	8
3	M8*40 Torx Screw	8
4	M8 spring washer	8
5	M8 flat gasket	8

G Fastener Assemblies (universal)		
NO.	PART NAME	QTY
1	M8*28 T-Screw	12
2	M8*38 T-Screw	12
3	M8 spring washer	12
4	M8 flat gasket	12
5	M8 Ball nut	12

F Track connector (universal)		
NO.	PART NAME	QTY
1	Track connector	8
2	M8*20 Torx Screw	8
3	M8 spring washer	8
4	M8 flat gasket	8

H Installation Tools (universal)		
NO.	PART NAME	QTY
1	4mm Hexagon wrench	1
2	T45 Wrench	1
3	T30 Wrench	1

Start to Install

1 As shown in the figure, open C (11).

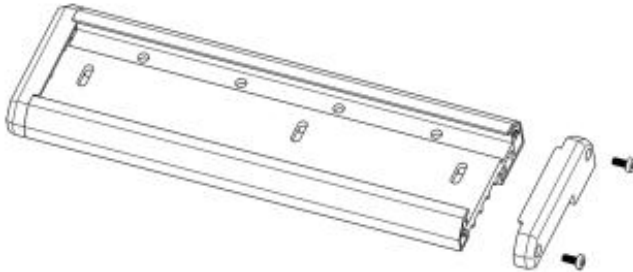

2 As shown in the figure, slide d (1,2), spin into d (3).



3 Sliding into C (2).

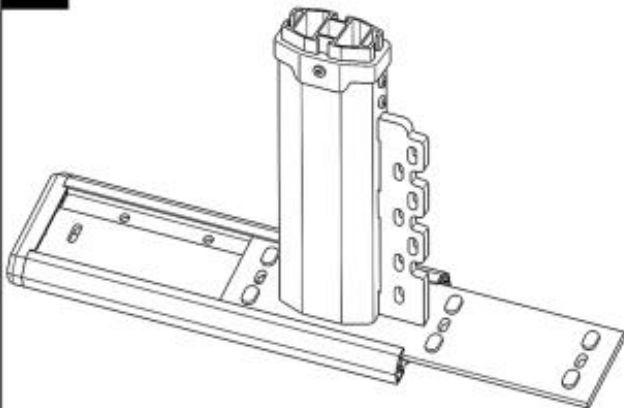

4 The installation is complete.



5 Sprinkle G (1,2,3,4).
Lock with G (5).

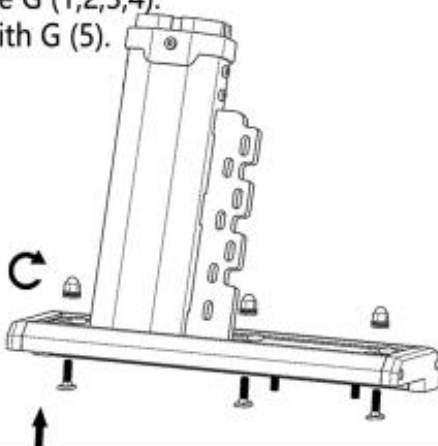

6 C installation is complete.

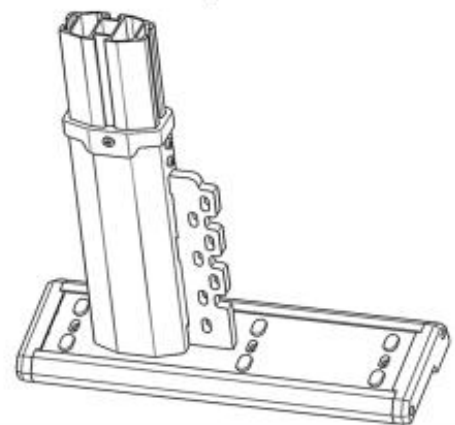

Installation method 1 (slip rail)

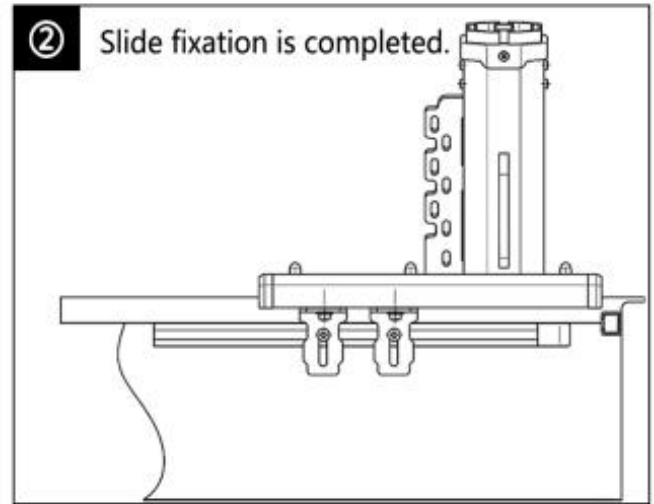
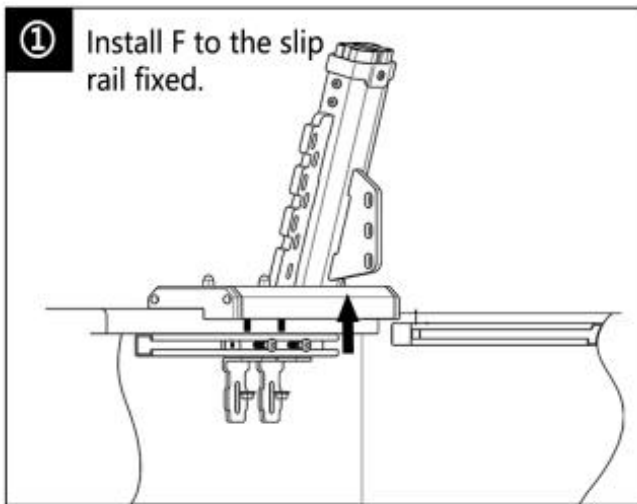

Installation method 2 (body)

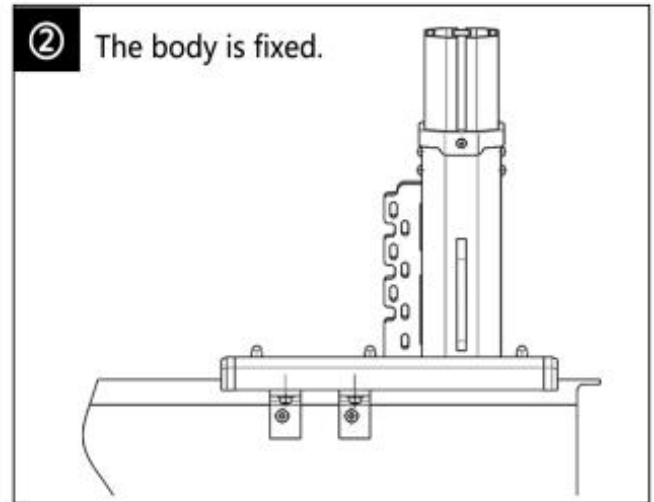
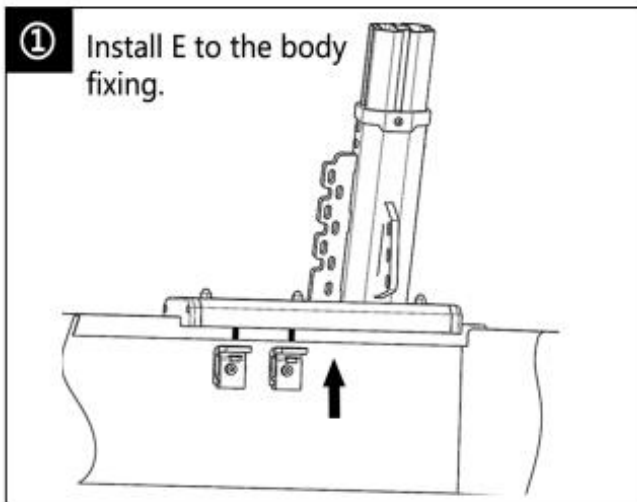

Installation method 3 (rolling curtain cover)

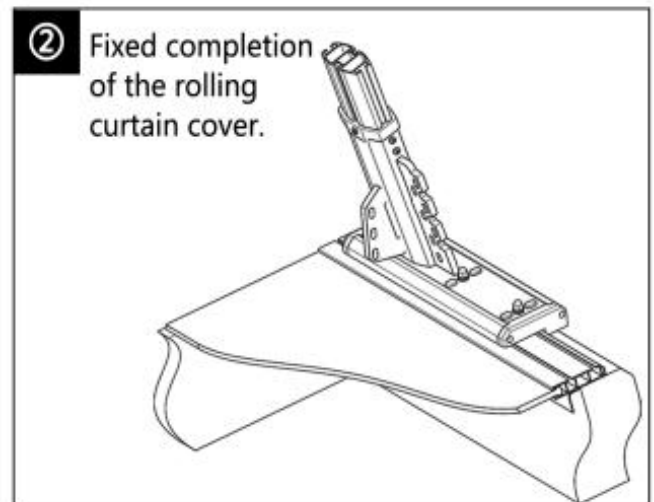
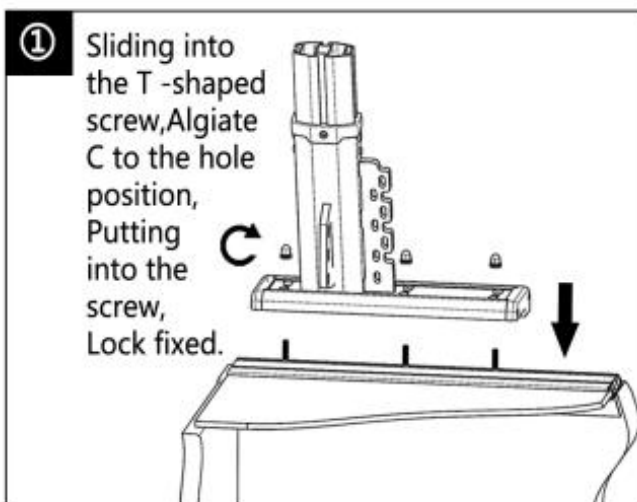

A2, B2 installation method

1 Install A2, B2.

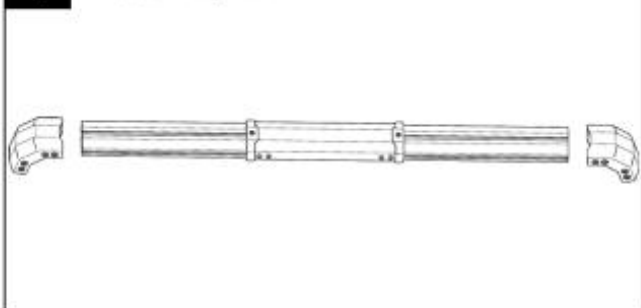

2 Install A2 (4,5,6).

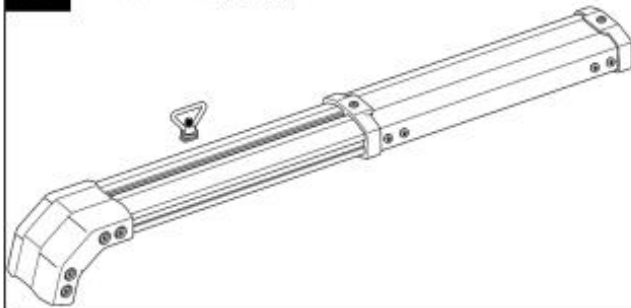

3 Assemble A2, B2 and C.

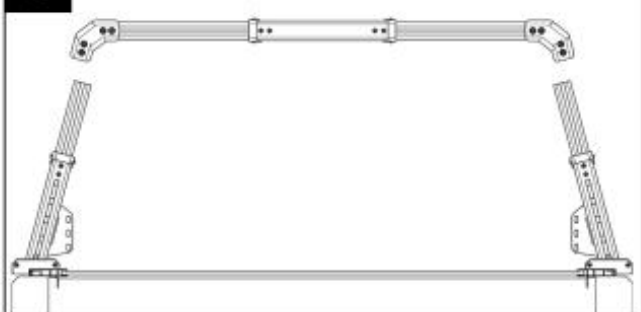

4 The installation is complete.

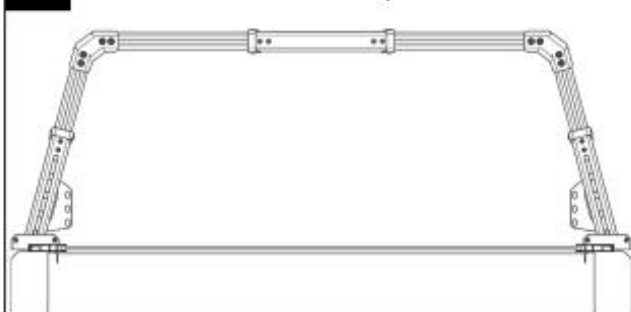

Pickup side box installation method

- 1** As shown in the figure, connect the brackets at both ends.

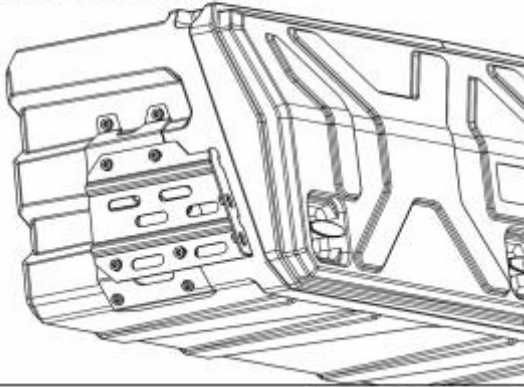

- 2** The same side is the same as above

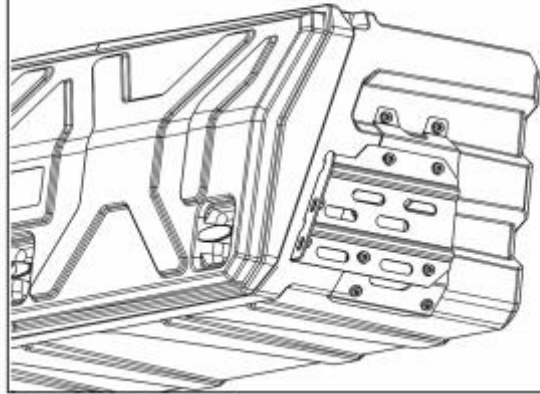

- 3** Connecting the Longmen frame C, the installation of pickup card side box is complete.

